

If you have questions or wishes concerning special applications:

BLUMAT-ADVISORY-SERVICE

www.blumat.info



How to work out your requirements:

1 Tropf Blumat waters approx. 25 cm of earth in diameter.

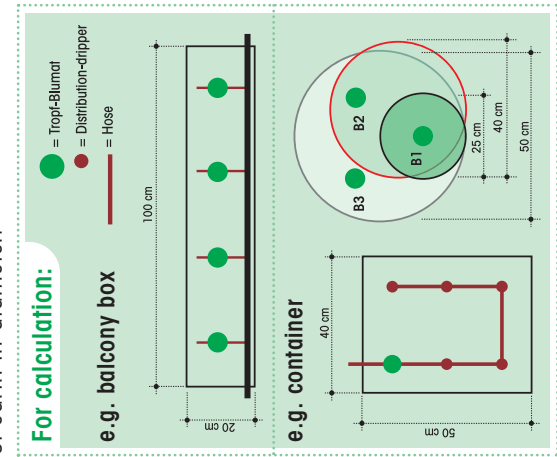

You require:

- e.g. to water balcony boxes of:
 - 100 cm length – at least 4 Tropf Blumats
 - 80 cm length – at least 3 Tropf Blumats
 - 60 cm length – at least 2 Tropf Blumats

- e.g. to water plant pots of:

- up to 25 cm Ø – 1 Tropf Blumat
- 25 – 40 cm Ø – 2 Tropf Blumats
- 40 – 50 cm Ø – 3 Tropf Blumats

Instead of additional Tropf Blumats, distribution-drippers can also be used for larger containers or for watering long flower beds.

1 Tropf Blumat and 5 distribution-drippers can water an area 20 cm wide and 1 m long.

Detach here.

www.blumat.info

A further innovation from our range.

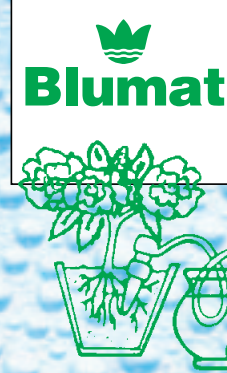

▶ A fully automatic watering system for HOUSE PLANTS.

- » The simpler Blumat system is perfect for the lower water consumption of house plants.
- » The water comes directly from the ceramic cone. The water supply is drawn from any container by means of a thin hose.
- » The Blumat is always standing by.
- » Your plants can stay in their customary location.
- » Transplanting is not necessary.
- » The Blumat can be used throughout the year and is ideal for watering your plants during vacations.



▶ With Blumat sets and the extension packages, you can install a custom trickling installation.

<p>Item No. 36001 Pressure reducer Ready to connect to the water tap</p>	<p>Item No. 32003 2 Tropf-Blumat Extension package</p>	<p>Item No. 30405 black Item No. 30504 white Water supply tube 10 m roll, 8 mm diameter</p>	<p>Item No. 32102 Shut Off Valve 8 mm (1/4")</p>	<p>Item No. 42002 Supports 10 supports for supply tube and distributor drippers</p>
<p>Item No. 35189 Mini-branch + Drip tube – 3 mini branch plus 3 m of drip tube for lengthening and creating a branch from the drip tube</p>	<p>Item No. 32805 Hose union 3 pieces for connecting supply tube, 8 mm diameter</p>	<p>Item No. 32904 Tee / End piece 2 of each for creating branches from supply tube, 8 mm diameter</p>	<p>Item No. 32706 Elbow 3 pieces for changing the direction of the supply tube, 8 mm diameter</p>	<p>Item No. 41005 Distributor dripper 10 distributor drippers plus 2 m of drip tube</p>



- 1 Tropf-Blumat-set for 3 m**
» Consisting of: 12 Tropf-Blumat, 7 m supply tube, 1 tank-connector and tube connections.
- 2 Tropf-Blumat-set for 10 m**
» Consisting of: 40 Tropf-Blumat, 15 m supply tube, 1 pressure reducer and several tube connections.

The starting point for your Blumat trickling system is one 3m or 10m-set. It can be expanded with items from our accessory line.

Maintenance and winter storage
When disassembling the system, the ceramic cone should be cleaned inside and out with water and stored in an area where it will not freeze. All tubes may be left outside.

Fertilization
Long-term fertilizers which are applied during planting are recommended. You can also fertilize the plants directly with the watering can.

If you have questions or wishes concerning special applications:

BLUMAT-ADVISORY-SERVICE

INFORMATION

Waters your plants perfectly



Whether you are home or not

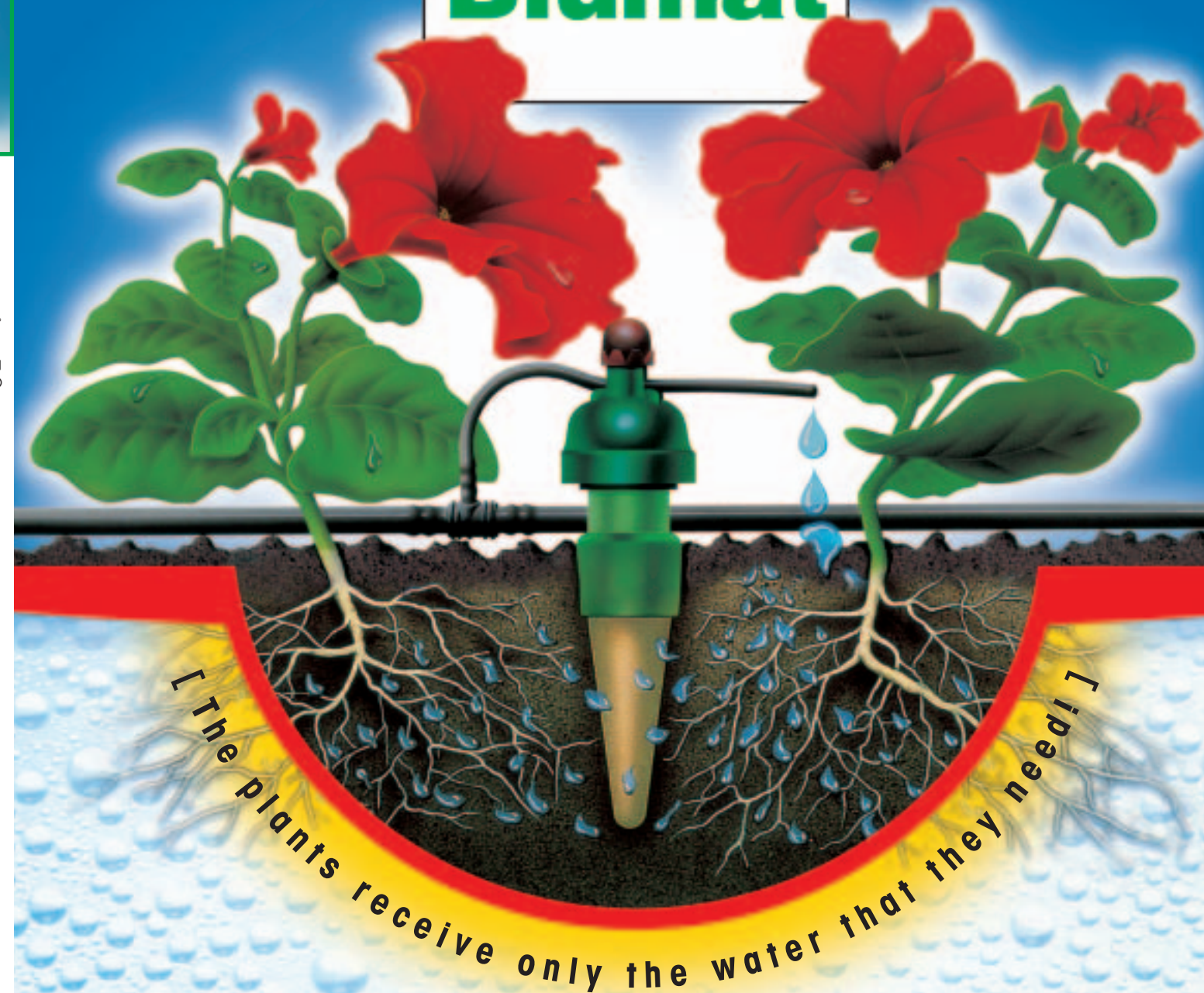

Ideal for planter boxes, containers, hanging baskets.

Fully automatic watering system.





Some good reasons for watering your plants with Blumat:

- » The Blumat trickling installation ensures luxurious growth on your balcony, healthy vegetables in your garden and flourishing plants in your home.
- » The secret lies in properly dosed, even and flexible watering.
- » In the summer months, your watering can pours out an average of 100 liters of water for balcony boxes, 200 liters for hanging potted plants such as surfinia, 350 liters for tomatoes and almost 1000 liters for angel's trumpets.

NOW YOU CAN SAVE

- » Save yourself the trouble of daily watering.
- » Save yourself the cost of unnecessary water consumption.
- » Save your plants from excessive and incorrect watering.

- » The Blumat trickling installation automatically controls the watering process.
- » The plants receive only the water that they need.
- » **Blumat systems work without the aid of a computer or electronic controls.**
- » You can entrust the watering of your plants to the Blumat systems and enjoy your vacation.



Where to use Tropf-Blumat?

For balconies, terraces, planters or hanging baskets:

Each earthenware cone acts both as a sensor and dripper! This makes the system unbeatable for all sorts of potted plants on your balcony or patio! You can use Tropf-Blumat for all kinds of plants.

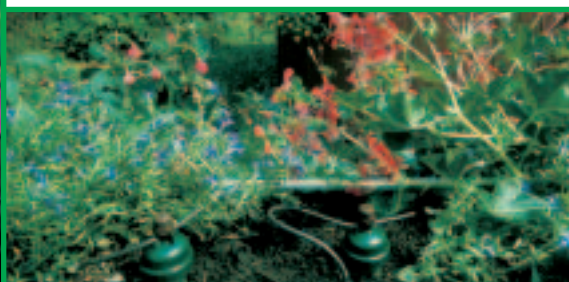

- » With the Tropf-Blumat, the ground's suction power is transferred to a membrane which opens and closes the water outlet.
- » Slow, dosed dripping ensures that your plants receive warmed water only.
- » Window boxes, regardless of which floor they are on, single plants on the terrace or the luxuriant green of the winter garden: The Tropf-Blumat is right for watering all kinds of plants. Differences in the height of the boxes or troughs are no problem.
- » Subsequent plantings are always possible with junction pieces.
- » The flexible system can be altered or expanded to include up to 500 drippers.

- » You can combine plants with varying levels of water consumption without hesitation.

- » Troublesome dripping after watering plants on the balcony is eliminated.

- » Nutrients being washed away by excessive watering is a thing of the past.

For greenhouses, allotment and roof-gardens, large-size containers, etc.

If particular, if you have the same sort of plants, you can also connect up a chain with a maximum of 5 distribution-drippers, instead of a second sensor, to the Tropf-Blumat.

- » Distribution-drippers should be used for watering long bed rows.

- » A Tropf-Blumat controls the watering of several different plants and distributes the water evenly by means of the distribution-drippers.

- » Use one Tropf-Blumat as sensor with distribution-drippers per variety for beds containing different species.



Unique function

The ceramic cone functions as a sensor and reacts to the moisture content of the earth surrounding it.

- » If the ground is dry, it triggers the trickling function with suction power. If the moisture level is sufficient, watering is automatically stopped.
- » Every Tropf-Blumat reacts fully automatically. It takes the sun's rays, air temperature and humidity and plant growth into account.
- » It is impossible for calcium deposits to form.

» The two illustrations clearly show this method of functioning:

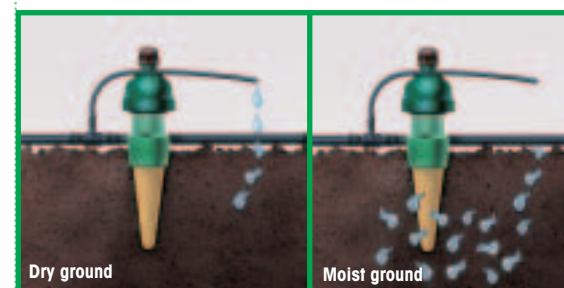

Easy and simple to fit:

Each set comes with detailed instructions. Don't forget to read these through before installing the system!

» Here they are in brief:

1 Fill the ceramic cone with water.



2 Soak the Tropf-Blumat in water for one hour. The ground must be watered generously.

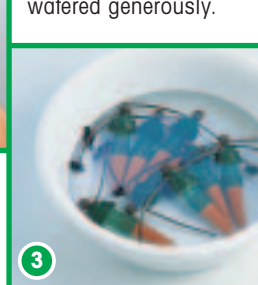

3 Screw back together tightly.

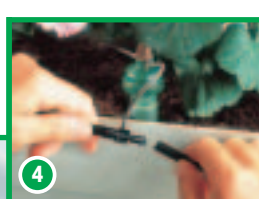

4 Cut the proper lengths from feeder hose and connect the Tropf-Blumat with them.

5 Close the setting screw by turning it slowly clockwise until just a water drip clings to the dripper hose.



Installation tips:

- » Practically invisible – the thin dripper hose, which can be used instead of the feeder hose.



- » Cable ducts (20 x 20 mm) make the supply hose almost invisible.

The tap or an elevated tank can be used as the water supply.

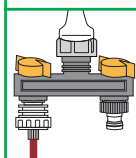

» Tip: Attach a 2-way distributor to the tap and you will have a second faucet.

- » These two types of water supply can be used with the Tropf-Blumat. We recommend using the tap with a pressure reducer, which allows you to use the garden tap even for watering plants on the balcony at a height of up to 4 m. Furthermore, refilling an elevated tank is unnecessary.

- » The pressure reducer decreases the water pressure to 1 bar (the maximum permissible pressure).



- 1 If an elevated tank must be used, it should stand at least 0,5 m higher than the plant container with a hose length of 5 m, and 1 m higher with a hose length of 10 m. The tank can also be installed at a greater height, e.g. on the roof.

- 2 When connecting to the water mains in your house, you will also require a pressure reducer. This will enable the system to water plants at a height up to 4 m and 3 m below the tap.

